

# TERMINAL UNITS

## APPLICATIONS

### RESIDENTIAL AND COMMERCIAL



WALL-MOUNTED

FLOOR OR CEILING

CASSETTES

FAN COIL UNITS

## A large range

- 4 terminal units types
- 19 sizes
- 12 models with infrared remote control in standard

**Design in accordance with European markets**

**The logical extension to be used with TECHNIBEL water chillers and heat pumps**



## Terminal Units

Wall type	MPW	<b>166</b>
Floor or ceiling type	KPSW	<b>168</b>
Cassette type	CWX	<b>170</b>
Fan coil units	TWN	<b>173</b>
Remote control for terminal units		<b>177</b>

# TERMINAL UNITS WALL TYPE

10 12 179  
MPW



## MPW

- > design
- > 5 models, 4 sizes
- > Compact units
- > A range with infrared remote control as standard
- > Same aesthetic for all the models

These models are especially recommended for rooms in which the floor must remain free or for water distribution systems in false ceilings.

### Functions

- Heating and cooling by 2 pipe coil
- Ventilation with filtration.

The active charcoal filter, available as an accessory, deodorises the air. It is used in addition to the standard dust filter.

### Accessory to be ordered imperatively

- Kit 3-way valve

### ACCESSORIES

Type	Models	Code
High efficiency filter with active charcoal (set of 2)	MPW 1 / 2 B5B/B5X MPW 3 / 4 B5B/B5X	397021909 397021910
Manual remote control RAB 30 Regulation by valve	MPW 1 / 2 / 3 / 4 B5B MPW 1 BE5B	70250076
Automatic remote control RCC 10 Regulation by valve	MPW 1 / 2 / 3 / 4 B5B	70250051
Automatic remote control RCC 20 Regulation by valve	MPW 1 BE5B	70250052
Air ambient temperature sensor, uncased for RCC (change over)	MPW 1 / 2 / 3 / 4 B5B MPW 1 BE5B	70250053
Remote room temperature sensor, cased, for RCC	MPW 1 / 2 / 3 / 4 B5B MPW 1 BE5B	70250054
3-way valve + by-pass – motorised 230V/1/50 Hz On/Off function – connection 1/2" M – Kvs 1.6 (To be fitted on the exterior of the unit when installing.)	All	70600071



Model		MPW 1	MPW 1 BE	MPW 2	MPW 3	MPW 4
Type		2 pipe coils	2 pipe coils + E	2 pipe coils	2 pipe coils	2 pipe coils
Codes - Models with infrared remote control		MPW 1B5X	-	MPW 2B5X	MPW 3B5X	MPW 4B5X
Codes - Models without infrared remote control		MPW 1B5B	MPW 1BE5B	MPW 2B5B	MPW 3B5B	MPW 4B5B
Total cooling capacity (kW)[1]	LS/MS/HS	0.80 / - / 1.24	0.80 / - / 1.24	0.96 / - / 1.67	1.91 / 2.53 / 3.17	2.62 / 3.14 / 3.67
Sensible cooling capacity (kW)[1]	LS/MS/HS	0.58 / - / 0.94	0.58 / - / 0.94	0.74 / - / 1.3	1.53 / 1.89 / 2.56	2.12 / 2.50 / 3.01
Heating capacity (kW)[2]	LS/MS/HS	1.11 / - / 1.72	1.11 / - / 1.72	1.49 / - / 2.38	2.70 / 3.50 / 4.50	3.70 / 4.50 / 5.50
Heating capacity by electric heater (kW)		-	0.5	-	-	-
Air flow (m <sup>3</sup> /s-m <sup>3</sup> /h)	LS	0.042 - 150	0.042 - 150	0.05 - 180	0.089 - 320	0.131 - 470
	MS	-	-	-	0.111 - 400	0.161 - 580
	HS	0.061 - 220	0.061 - 220	0.075 - 270	0.142 - 510	0.197 - 710
Water flow in cooling (l/h) [1]	HS	215	215	290	545	630
Pressure drop on water in cooling mode (kPa) [1]	HS	16.1	16.1	27.2	20	27
Pressure drop on water in heating mode (kPa) [2]	HS	15.3	15.3	26.2	19	26
Electrical power supply (V/ph/Hz)		230/1/50	230/1/50	230/1/50	230/1/50	230/1/50
Maximum input power (kW)	HS	0.025	0.525	0.025	0.075	0.08
Maximum running current (A)	HS	0.11	2.3	0.11	0.33	0.36
Hydraulic connection		1/2" G female	1/2" G female	1/2" G female	1/2" G female	1/2" G female
Sound power level (dBA)	LS/MS/HS	32 / - / 41	32 / - / 41	35 / - / 45	46 / 52 / 58	48 / 53 / 59
Sound pressure level (dBA) at 2 m indoors	LS/MS/HS	23 / - / 32	23 / - / 32	26 / - / 36	37 / 43 / 49	39 / 44 / 50

The pressure levels here indicated are in compliance with the European standard EN 12102

10 kPa = 1mCE

#### Nominal conditions

(1) Air inlet	27°C (DB) / 19°C (WB)	(2) Air inlet	20°C
Water inlet	7°C	Water inlet	50°C (same water flow as in condition (1))
Water outlet	12°C	T maxi at water inlet	60°C

## PRECAUTIONS FOR INSTALLATION AND PHYSICAL CHARACTERISTICS

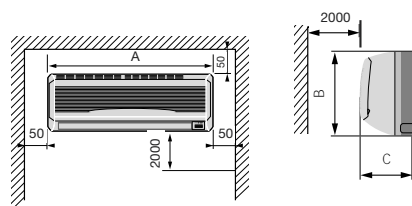

Dimensions in mm

	A (mm)	B (mm)	C (mm)	Weight (kg)
MPW 1	805	270	215	8
MPW 2	805	270	215	8
MPW 3	995	285	240	11
MPW 4	995	285	240	11

# TERMINAL UNITS FLOOR OR CEILING TYPE

10 12 171  
KPSW



## KPSW

- > 3 sizes
- > Aesthetic and silence
- > Range with infrared remote control as standard

The attractive slimline KPSW units can be installed as console or ceiling mounted units (to leave floor and wall space free): this permits uniform installation throughout the building.

### Functions

- Heating and cooling by 2 pipe coil
- Ventilation with filtration.

The active charcoal filter, available as an accessory, deodorises the air. It is used in addition to the standard dust filter.

### Accessory to be ordered imperatively

- Kit 3-way valve

### ACCESSORIES

Type	Models	Code
High efficiency filter with active charcoal	KPSW 2/3/4 B5B/B5X	397021907
Set of 2 insulated hoses for hydraulic connection	length 1 250 mm length 550 mm	KPSW 2/3/4 B5B/B5X KPSW 2/3/4 B5B/B5X
Manual remote control RAB 30 Regulation by valve	KPSW 2/3/4 B5B	70600059 70600060
Automatic remote control RCC 10 Regulation by valve	KPSW 2/3/4 B5B	70250076
Air ambient temperature sensor, uncased for RCC [change over or air intake]	KPSW 2/3/4 B5B	70250051
Remote room temperature sensor, cased, for RCC	KPSW 2/3/4 B5B	70250053
3-way valve + by-pass – motorised 230V/1/50 Hz On/Off function – connection 1/2" M – Kvs 1.6 [To be fitted on the exterior of the unit when installing.]	All	70250054 70600071



Model		KPSW 2	KPSW 3	KPSW 4
Type		2 pipe coils	2 pipe coils	2 pipe coils
Codes - Models with infrared remote control		KPSW 2 B5X	KPSW 3 B5X	KPSW 4 B5X
Codes - Models without infrared remote control		KPSW 2 B5B	KPSW 3 B5B	KPSW 4 B5B
Total cooling capacity (kW)(1)	LS/MS/HS	1.07 / 1.80 / 2.40	1.13 / 2.40 / 3.19	1.77 / 3.00 / 3.60
Sensible cooling capacity (kW)(1)	LS/MS/HS	0.93 / 1.50 / 1.97	0.95 / 1.80 / 2.47	1.48 / 2.50 / 3.06
Heating capacity (kW)(2)	LS/MS/HS	1.84 / 2.70 / 3.48	2.05 / 3.40 / 4.07	2.40 / 4.30 / 5.30
Air flow (m <sup>3</sup> /s-m <sup>3</sup> /h)	LS	0.056/200	0.058/210	0.092/330
	MS	0.083/300	0.119/430	0.158/570
	HS	0.115/415	0.144/520	0.188/675
Water flow in cooling (l/h) (1)	HS	420	550	617
Pressure drop on water in cooling mode (kPa) (1)	HS	21	26.6	25.8
Pressure drop on water in heating mode (kPa) (2)	HS	13	23.7	23
Electrical power supply (V/ph/Hz)		230/1/50	230/1/50	230/1/50
Maximum input power (kW)	HS	0.034	0.046	0.080
Maximum running current (A)	HS	0.16	0.23	0.40
Hydraulic connection		1/2" G male	1/2" G male	1/2" G male
Sound power level (dBA)	LS/MS/HS	35 / 43 / 48	35 / 45 / 50	40 / 51 / 54
Sound pressure level (dBA) to 2 m indoors	LS/MS/HS	27 / 35 / 40	27 / 37 / 42	32 / 43 / 46

The pressure levels here indicated are in compliance with the European standard EN 12102

10 kPa = 1mCE

#### Nominal conditions

(1) Air inlet	27°C (DB) / 19°C (WB)	(2) Air inlet	20°C
Water inlet	7°C	Water inlet	50°C (same water flow as in condition (1))
Water outlet	12°C	T maxi at water inlet	60°C

## PRECAUTIONS FOR INSTALLATION AND PHYSICAL CHARACTERISTICS

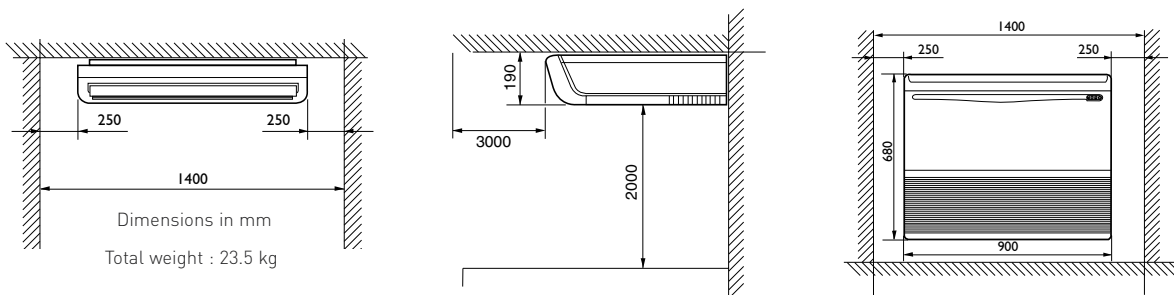

# TERMINAL UNITS CASSETTE TYPE

10 12 156  
CWX 3/5



CWX 3,  
CWX 5  
(600 X 600)

- > 2 sizes, 6 models
- > 2 models with infrared remote control as standard

The CWX 3 and CWX 5 cassettes are a chilled water terminal unit designed for service sector premises such as shops, offices and hotels.

This appliance can be used for either heating or cooling, when using hot or cold water circulation. The CWX 3 BE and CWX 5 BE use cold water for cooling and are equipped with an electric heater for heating.

These cassettes units can be installed extremely discreetly, their dimensions (600 x 600) being the same as those of a false ceiling panel.

These cassettes are fitted with a manual air vent and a condensate drain pump. They are pre-punched (Ø 70 mm) to enable connection with fresh air intake.

## Functions

- Heating and cooling by 2 pipe coil
- Ventilation with filtration (regenerable filter)

## Accessory to be ordered imperatively

- Kit 3-way valve

Models		CWX 3 B	CWX 3 BE	CWX 3 BW	CWX 5 B	CWX 5 BE	CWX 5 BW
Type		2 pipe coils	2 pipe coils + E	4 pipe coils	2 pipe coils	2 pipe coils + E	4 pipe coils
Codes - Models with infrared remote control		CWX 3 B5X	-	-	CWX 5 B5X	-	-
Codes grille - Models with infrared remote control		K 70 N 129 T	-	-	K 70 N 129 T	-	-
Codes - Models without infrared remote control		CWX 3 B5B	CWX 3 BE5B	CWX 3 BW5B	CWX 5 B5B	CWX 5 BE5B	CWX 5 BW5B
Codes grille - Models without infrared remote control		K 70 N 090 T	K 70 N 090 T	K 70 N 090 T	K 70 N 090 T	K 70 N 090 T	K 70 N 090 T
Total cooling capacity (kW) <sup>(1)</sup>	LS/MS/HS	2.15/2.35/2.60	1.72/1.88/2.08	1.72/1.88/2.08	3.60/4.10/4.70	3.24/3.69/4.23	2.88/3.28/3.76
Sensible cooling capacity (kW) <sup>(1)</sup>	LS/MS/HS	1.91/2.09/2.31	1.53/1.67/1.85	1.53/1.67/1.85	2.80/3.21/3.72	2.52/2.89/3.35	2.24/2.56/2.98
Heating capacity (kW) <sup>(2)</sup>	LS/MS/HS	2.83/3.11/3.49	2.4/2.64/2.96	-	4.35/4.85/5.70	3.92/4.37/5.13	-
Heating capacity by electric heater (kW)		-	1.25	-	-	2.50	-
Heating capacity additional coil (kW) <sup>(3)</sup>	LS/MS/HS	-	-	1.22/1.34/1.51	-	-	1.78/1.98/2.33
Air flow	(m³/s) / (m³/h) / LS/MS/HS	0.11/0.128/0.144 / 400/460/520	0.11/0.128/0.144 / 400/460/520	0.11/0.128/0.144 / 400/460/520	0.147/0.175/0.208 / 530/630/750	0.147/0.175/0.208 / 530/630/750	0.147/0.175/0.208 / 530/630/750
Water flow in cooling (l/h) <sup>(1)</sup>	HS	447	358	358	790	728	647
Water flow additional coil (l/h) <sup>(3)</sup>	HS	-	-	108	-	-	167
Pressure drop on water in cooling mode (kPa) <sup>(1)</sup> HS		22	22	22	42	42	42
Pressure drop on water in heating mode (kPa) <sup>(2)</sup> HS		18	18	-	33	33	-
Pressure drop on water additional coil (kPa) <sup>(3)</sup>	HS	-	-	18	-	-	32
Electrical power supply (V/ph/Hz)		230/1/50	230/1/50	230/1/50	230/1/50	230/1/50	230/1/50
Maximum power input (kW)	HS	0.060	1.310	0.060	0.090	2.590	0.090
Maximum current input (A)	HS	0.25	5.70	0.25	0.40	11.30	0.40
Hydraulic connection		1/2" G fem.	1/2" G fem.	1/2" G fem.	1/2" G fem.	1/2" G fem.	1/2" G fem.
Sound power level (dBA)	LS/MS/HS	40 / 43 / 46	40 / 43 / 46	40 / 43 / 46	48 / 51 / 55	48 / 51 / 55	48 / 51 / 55
Sound pressure level (dBA) <sup>(4)</sup>	LS/MS/HS	31 / 34 / 37	31 / 34 / 37	31 / 34 / 37	39 / 42 / 46	39 / 42 / 46	39 / 42 / 46

The pressure levels here indicated are in compliance with the European standard EN 12102

### Nominal conditions

(1) Air inlet 27°C (DB) / 19°C (WB)  
Water inlet 7°C  
Water outlet 12°C

(2) Water inlet 20°C  
Water outlet 50°C / same water flow as condition (1) (2 pipe coils)  
(3) Water inlet 20°C  
Water outlet 70°C (4 pipe coils)  
Water outlet 60°C (4 pipe coils)

(4) to 2 m indoors

# TERMINAL UNITS CASSETTE TYPE

10 12 158  
CWX 6/8/10



CWX 6,  
CWX 8,  
CWX 10

- > 3 sizes
- > 3 models with infrared remote control as standard

The CWX 6,8 and 10 cassettes are chilled water terminal units designed for service sector premises such as shops, offices and hotels.

## Functions

- Heating and cooling by 2 pipe coil
- Ventilation with filtration (regenerable filter)

They can be installed in a false ceiling in order to hide the supply pipes and leave wall space completely clear. These cassettes are fitted with a manual air vent and a condensate drain pump.

## Accessory to be ordered imperatively

- Kit 3-way valve

Models		CWX 6	CWX 8	CWX 10
Type		2 pipe coils	2 pipe coils	2 pipe coils
Codes - Models with infrared remote control		CWX 6 B5X	CWX 8 B5X	CWX 10 B5X
Codes grille - Models with infrared remote control		K 70 N 130 T	K 70 N 131 T	K 70 N 131 T
Codes - Models without infrared remote control		CWX 6 B5B	CWX 8 B5B	CWX 10 B5B
Codes grille - Models without infrared remote control		K 70 N 094 T	K 70 N 095 T	K 70 N 095 T
Total cooling capacity (kW) [1]	LS/MS/HS	4.20 / 5.00 / 6.00	5.50 / 6.50 / 8.00	6.23 / 8.09 / 9.92
Sensible cooling capacity (kW) [1]	LS/MS/HS	3.20 / 3.80 / 4.70	4.10 / 5.40 / 6.40	4.62 / 6.22 / 7.90
Heating capacity (kW) [2]	LS/MS/HS	5.40 / 6.40 / 7.70	6.28 / 8.52 / 9.42	7.34 / 9.53 / 11.69
Air flow	(m³/s) (m³/h) LS/MS/HS	0.233 / 0.294 / 0.361 850 / 1060 / 1300	0.231 / 0.303 / 0.353 830 / 1090 / 1270	0.339 / 0.472 / 0.631 1200 / 1700 / 2300
Water flow in cooling (l/h) [1]	HS	1030	1380	1700
Pressure drop on water in cooling mode (kPa) [1]		30	41	63
Pressure drop on water in heater mode (kPa) [2]		27	39	60
Electrical power supply (V/ph/Hz)		230/1/50	230/1/50	230/1/50
Maximum input power (kW)	HS	0.120	0.120	0.180
Maximum running current (A)	HS	0.5	0.5	0.8
Hydraulic connection		3/4" G fem.	3/4" G fem.	3/4" G fem.
Sound power level (dBA)	LS/MS/HS	40 / 44 / 51	37 / 46 / 50	43 / 49 / 57
Sound pressure level (dBA) [3]	LS/MS/HS	31 / 35 / 42	28 / 37 / 41	34 / 40 / 48

The pressure levels here indicated are in compliance with the European standard EN 12102

### Nominal conditions

[1] Air inlet	27°C (DB) / 19°C (WB)	[2] Air inlet	20°C
Water inlet	7°C	Water inlet	50°C / same water flow as
Water outlet	12°C	conditions [1]	
		[3] to 2 m indoors	

# TERMINAL UNITS CASSETTE TYPE

## ACCESSORIES

Type	Models	Code
Manual remote control RAB 30		
Regulation by On/Off valve control	CWX 3/5/6/8/10 B5B - CWX 3/5 BW5B	70250076
Regulation by On/Off valve control Cool + electric heater	CWX 3/5 BE5B	70250076
Automatic remote control RCC 10	CWX 3/5/6/8/10 B5B	70250051
Regulation by On/Off valve control		
Automatic remote control RCC 20	CWX 3/5 BE5B/BW5B	70250052
Regulation by On/Off valve control		
Remote room temperature sensor uncased for RCC		
- for change over	CWX 3/5/6/8/10 B5B - CWX 3/5 BE5B	70250053
- for air intake	All	70250053
Remote room temperature sensor, cased, for RCC	All	70250054
3-way valve + by-pass motorised 230V/1/50Hz	Cassette 2 pipes 1/2" 3/4"	CWX 3/5 B5B/BE5B/B5X 70600088 70600089
On/Off function	Cassette 4 pipes 1/2"	CWX 3/5 BW5B 70600088 x 2
[To be fitted on the exterior of the unit when installing.]		

### CWX 3/5

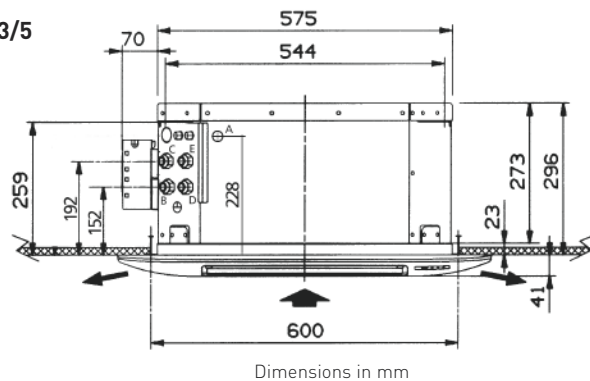

Dimensions in mm

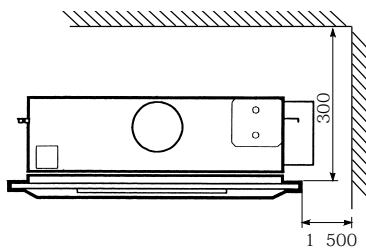

- A Condensate drain : Ø 10 mm
- B Main Coil water inlet : 1/2" (female)
- C Main Coil water outlet : 1/2" (female)
- D Additional coil water inlet : 1/2" (female)
- E Additional coil water outlet : 1/2" (female)

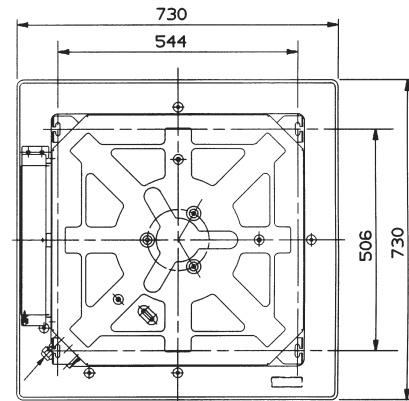

- Empty weight : 18 kg CWX 3  
20 kg CWX 5
- Grille : 3 kg

Pump lift above unit : 200 mm

### CWX 6/8/10

	L	H	X	Y	Z
<b>CWX 6</b>	760	310	260	860	500
<b>CWX 8/10</b>	1 050	340	290	1 150	750

	CWX 6	CWX 8/10	A	B
Unit	23 kg	29 kg	820	566
Façade/assembly	5 kg	7 kg	1 110	853

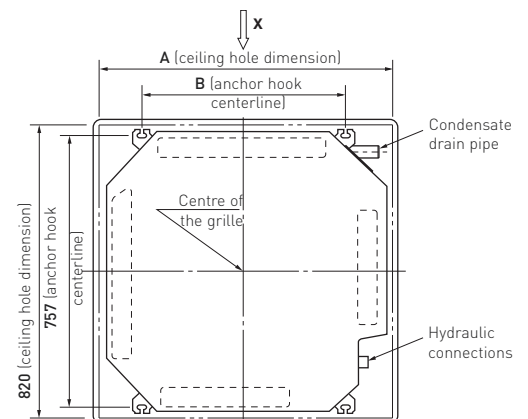
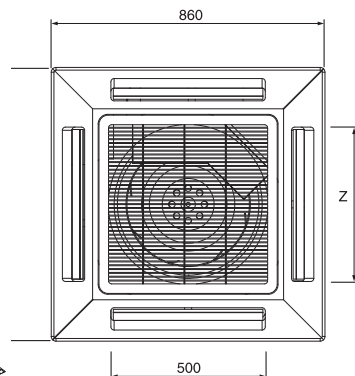
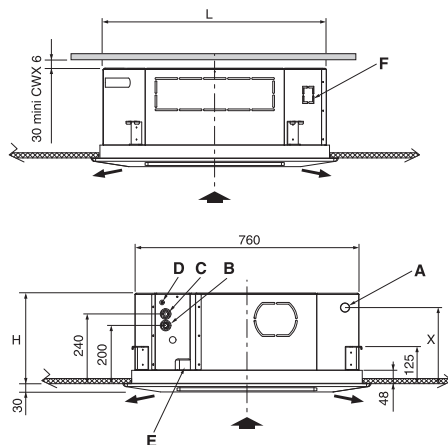

- A Condensate drain: Ø32 mm outdoor
- B Water inlet: 3/4" gaz female
- C Water outlet: 3/4" gaz female
- D Air vent valve
- E Electrical cable passage
- F Fresh air intake: 60 mm x 55 mm

Pump lift above unit : 250 mm

# TERMINAL UNITS FAN COIL UNITS

10 12 172  
TWN



## TWN

- > Rounded and harmonious lines
- > 7 sizes
- > 5 types of installation

TWN fan coil units include 7 sizes in 2 pipe version, each size being designed to match 5 types of installation:

**TWN - CV** : vertical installation with casing

**TWN - CH** : horizontal installation or floor model with casing

**TWN - NC** : horizontal or vertical installation without casing

The factory-fitted options and the accessories extend the range to include a 2 pipe + electric heater version and a 4 pipe version.

- painted metal sheet casing

- synthetic air filter
- copper / aluminium coil with left hand side connection (can be changed on site).

### Functions common to all models

- Heating and cooling by 2 pipe coil
- Ventilation with filtration

### MODELS

		Size	Code	
Models without casing		02	TWN 02 NC 00T	
		03	TWN 03 NC 00T	
		04	TWN 04 NC 00T	
		05	TWN 05 NC 00T	
		06	TWN 06 NC 00T	
	Models with casing		08	TWN 08 NC 00T
			11	TWN 11 NC 00T
02			TWN 02 CV 00T	
03			TWN 03 CV 00T	
04			TWN 04 CV 00T	
05			TWN 05 CV 00T	
06			TWN 06 CV 00T	
Models with casing		08	TWN 08 CV 00T	
		11	TWN 11 CV 00T	
		02	TWN 02 CH 00T	
		03	TWN 03 CH 00T	
		04	TWN 04 CH 00T	
		05	TWN 05 CH 00T	
		06	TWN 06 CH 00T	
	08	TWN 08 CH 00T		
	11	TWN 11 CH 00T		

# TERMINAL UNITS FAN COIL UNITS



Size		02	03	04	05	06	08	11
Total cooling capacity (kW) (1)	LS	1.45	1.76	2.51	3.17	3.97	4.49	6.97
	MS	1.81	2.38	3.27	3.87	5.27	6.78	8.77
	HS	2.09	2.93	4.33	4.77	6.71	8.71	10.95
Sensible cooling capacity (kW) (1)	LS	1.05	1.26	1.80	2.32	2.84	3.25	5.12
	MS	1.31	1.70	2.45	2.92	3.83	4.94	6.46
	HS	1.51	2.11	3.15	3.65	4.91	6.38	8.07
Heating capacity (kW) 2 pipe coil (2)	LS	1.79	2.28	3.29	4.24	4.77	5.65	8.90
	MS	2.18	3.08	4.30	5.21	6.23	8.46	11.1
	HS	2.79	3.81	5.63	6.36	7.83	11.1	14.5
Electric Heater power (kW) (3)		1.5	1.6	2.0	2.0	3.0	3.0	-
Heating capacity (kW) 4 pipe coil (4)	LS	1.79	2.3	3.47	4.04	5.69	6.12	8.82
	MS	2.04	2.83	4.19	4.65	6.83	7.95	10.21
	HS	2.3	3.26	5.04	5.30	7.91	9.30	12.14
Air flow (m³/s-m³/h) (5)	LS	0.058-211	0.067-241	0.100-361	0.130-470	0.158-570	0.178-642	0.280-1010
	MS	0.075-271	0.094-341	0.138-497	0.168-605	0.214-771	0.284-1022	0.366-1317
	HS	0.095-344	0.123-442	0.196-706	0.218-785	0.280-1011	0.387-1393	0.514-1850
Water flow in cooling (l/h) (1)	LS	249	302	431	544	681	771	1 196
	MS	311	408	561	664	904	1 163	1 505
	HS	359	503	743	818	1 152	1 494	1 879
Water flow additional coil (l/h) (4)	LS	157	202	304	355	499	537	773
	MS	179	249	367	408	600	698	896
	HS	202	286	442	465	694	816	1 065
Maximum static pressure (Pa) (10)	MS/HS	40/60	40/60	60/60	60/60	60/60	60/60	60/60
Pressure drop on water cooling mode (kPa) (1)	LS	7	5	5	7	5	6	14
	MS	10	8	8	10	8	12	21
	HS	13	11	12	14	12	19	31
Pressure drop on water heating mode (kPa) 2 pipe coil (2)	LS	5	4	4	6	4	5	12
	MS	8	6	6	8	6	11	17
	HS	10	9	9	12	9	16	25
Pressure drop on water heating mode (kPa) 4 pipe coil (4)	LS	5	3	5	6	15	17	29
	MS	6	4	7	8	21	27	37
	HS	8	5	10	10	27	36	50
Fan motor characteristics (6) (W) 230 V/1/50 Hz (7) (A)		53	56	98	98	182	244	310
		0.24	0.25	0.44	0.44	0.80	1.12	1.52
Hydraulic connection	2 pipes	1/2" G Fem.	1/2" G Fem.	1/2" G Fem.	1/2" G Fem.	3/4" G Fem.	3/4" G Fem.	3/4" G Fem.
	4 pipes	Cooling: 1/2" G Fem.	1/2" G Fem.	1/2" G Fem.	1/2" G Fem.	3/4" G Fem.	3/4" G Fem.	3/4" G Fem.
	Heating: 1/2" G Fem.	1/2" G Fem.	1/2" G Fem.	1/2" G Fem.	1/2" G Fem.	1/2" G Fem.	1/2" G Fem.	
Sound power level (dBA) (8)	LS/MS/HS	36/44/50	33/41/47	35/43/52	43/49/56	47/54/61	49/59/66	60/64/71
Sound pressure level (dBA) (9)	LS/MS/HS	29/35/41	24/32/38	26/34/43	34/40/47	38/45/52	40/50/57	51/55/62

The pressure levels here indicated are in compliance with the European standard EN 12102

Fem. = female

## Nominal conditions

(1) Air inlet 27°C (DB)/19°C (WB)

Water 7°C / 12°C

(2) Air inlet 20°C

Water inlet 50°C, same water flow (1)

(3) As accessory, limited static pressure (see specifications sheet)

Operation is forbidden with a 2 pipe system (cooling and heating)

(4) Air inlet 20°C

Water 70°C / 60°C

(5) Measurement with direct air outlet

(available pressure = 0 Pa)

T Air inlet 20°C

(6) Total input power (at high speed)

(7) Total running current (at high speed)

(8) Tests performed in compliance with standard ISO 3741 and ISO 3742

(9) at 2 m indoors

(10) Applications requiring static pressure should not use the LS function.

**For concealed NC models, capacities must be adjusted according to air pressure drop (See technical manual)**

## ACCESSORIES OR FACTORY-FITTED OPTIONS

Type	Model	Accessories code	Factory-fitted options code
speeds select switch - On/Off (*) (3 speeds , M/A)	CV - CH (vertical)	K 70 P 034 Z	K 70 P 034 M
Regulation by ventilation control (fixe) (3 speeds - On/Off - electromechanical thermostat) Cooling only <b>or</b> heating only	CV 2 pipe coils CH (vertical) 2 pipe coils	K 70 P 035 Z	K 70 P 035 M
Regulation by ventilation control (3 speeds - On/Off electromechanical thermostat manual changeover)	CV 2 pipe coils CH (vertical) 2 pipe coils	K 70 P 036 Z	K 70 P 036 M
Electronic regulation, LCD display (1) 1 Valve or 2 valves or 1 valve + electric heater automatic changeover	CV or CH (vertical) 2 pipe coils / 4 pipe coils 2 pipe coils cooling + E	K 70 P 090 Z	K 70 P 090 M
Electronic regulation, LCD display (1) 1 Valve or 2 valves or 1 valve + electric heater automatic changeover. "Master/Slave" system	CV or CH (vertical) 2 pipe coils / 4 pipe coils 2 pipe coils Cooling + E	K 70 P 091 Z	K 70 P 091 M
(1) Built-in assembly kit (cladding + air probe)	K 70 P 090 Z K 70 P 091 Z	K 70 P 092 Z	-
Remote water/air sensor	K 70 P 090 Z K 70 P 091 Z	K 70 P 093 Z	-
Remote humidity sensor	K 70 P 091 Z	K 70 P 094 Z	-
Control panel for motorised damper	CV	K 70 P 040 Z	K 70 P 040 M
Kit 3-way valve + bypass, motorised 230V/1/50 Hz On/Off function for main heating coil (recommended accessory: auxiliary drain pan)	1/2" G M - Kvs 1.7 3/4" G M - Kvs 2.8 3/4" G M - Kvs 2.8	Sizes 02 - 03 K 70 L 047 Z K 70 L 048 Z K 70 L 049 Z	Sizes 04 - 05 K 70 L 048 M K 70 L 049 M
Kit 3-way valve + bypass, motorised 230V/1/50 Hz On/Off function for additional heating coil (recommended accessory: auxiliary drain pan)	1/2" G M - Kvs 1.7 1/2" G M - Kvs 1.7	Sizes 02 to 05 K 70 L 050 Z K 70 L 051 Z	Sizes 06 to 11 K 70 L 051 M
Additional heating coil for 4 pipe system	Size 02 Size 03 Sizes 04 - 05 Sizes 06 - 08 Size 11	K 70 B 009 Z K 70 B 010 Z K 70 B 011 Z K 70 B 012 Z K 70 B 013 Z	K 70 B 009 M K 70 B 010 M K 70 B 011 M K 70 B 012 M K 70 B 013 M
Electric heater kit	1,5 kW 1,6 kW 2,0 kW 3,0 kW	Size 02 Size 03 Sizes 04 - 05 Sizes 06 - 08	K 70 C 040 Z K 70 C 041 Z K 70 C 042 Z K 70 C 043 Z

\* The select switch does not provide temperature control.

\*\* This regulation is not recommended for the applications: «1 zone with terminal units» and «combination solution underfloor and terminal units» of our residential solutions with air/water heat pumps

## PHYSICAL CHARACTERISTICS

### CASED UNITS

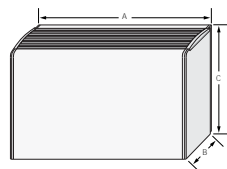

TWN - CV  
Vertical model with casing

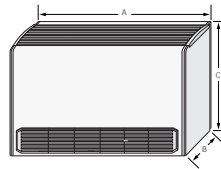

TWN - CH  
Floor model with casing

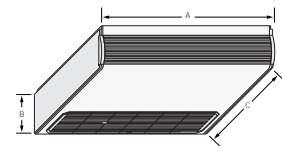

TWN - CH  
Concealed model, horizontal mounting

### CONCEALED UNITS

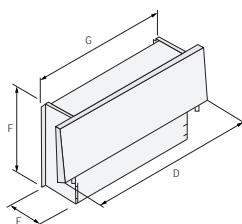

TWN - NC  
For horizontal or vertical installation

	A (mm)	B (mm)	C (mm)	D (mm)	E (mm)	F (mm)	G (mm)
Size 02	774	226	564	584	224	535	498
Size 03	984	226	564	794	224	535	708
Size 04-05	1 194	226	564	1 004	224	535	918
Size 06-08	1 404	251	564	1 214	249	535	1 128
Size 11	1 614	251	564	1 424	249	535	1 338

# TERMINAL UNITS FAN COIL UNITS

ACCESSORIES	Model	Code
Power interface kit to control four fan coil units with 1 control	Tous modèles	K 70 P 095 Z
Manual remote control RAB 30 + manual changeover Regulation by On/Off valve Regulation by On/Off valves	2 pipe coils 4 pipe coils	70250076
Electronic LCD display	2 pipe coils / 4 pipe coils 2 pipe coils Cooling + E	K 70 P 090 Z
Electronic remote control, LCD display, "Master/Slave" system	2 pipe coils / 4 pipe coils 2 pipe coils Cooling + E	K 70 P 091 Z
Remote water/air sensor	K 70 P 090 Z K 70 P 091 Z	K 70 P 093 Z
Remote humidity sensor	K 70 P 091 Z	K 70 P 094 Z
Automatic remote control RCC 20 Regulation by ventilation (control) Regulation by On/Off valve (cooling) + electric heater	2 pipe coils 2 pipe coils + E	70250052
Automatic remote control RCC 10 Regulation by ventilation (fixe) Regulation by On/Off valve (Heating or Cooling)	2 pipe coils 2 pipe coils	70250051
Remote room temperature sensor in box for 70250051 and 70250052		70250054
Remote room temp. sensor uncased for 70250051 and 70250052		70250053
Control panel for motorised damper	CV - NC (vertical)	K 70 D 032 Z
Manual fresh air damper for vertical unit CV and NC	Size 02 Size 03 Sizes 04 - 05 Sizes 06 - 08	K 70 N 120 Z K 70 N 121 Z K 70 N 122 Z K 70 N 123 Z
Motorised fresh air damper for vertical unit CV and NC	Size 02 Size 03 Sizes 04 - 05 Sizes 06 - 08 Size 11	K 70 N 124 Z K 70 N 125 Z K 70 N 126 Z K 70 N 127 Z K 70 N 128 Z
Air discharge adjustable single deflection grille for cased units CH, CV	Size 02 Size 03 Sizes 04 - 05 Sizes 06 - 08 Size 11	K 70 N 054 Z K 70 N 055 Z K 70 N 056 Z K 70 N 057 Z K 70 N 058 Z
Outdoor air intake grid (with frame)	Size 02 Size 03 Sizes 04 - 05 Sizes 06 - 08	K 70 N 059 Z K 70 N 060 Z K 70 N 061 Z K 70 N 062 Z
Indoor air return grid with filter and frame for concealed units NC	Size 02 Size 03 Sizes 04 - 05 Sizes 06 - 08	K 70 N 063 Z K 70 N 064 Z K 70 N 065 Z K 70 N 066 Z
Indoor air discharge grid with filter and frame for concealed units NC	Sizes 02 Size 03 Sizes 04 - 05 Sizes 06 - 08	K 70 N 067 Z K 70 N 068 Z K 70 N 069 Z K 70 N 070 Z
Painted rear plate for CH (vertical unit) and CV for window units	Size 02 Size 03 Sizes 04 - 05 Sizes 06 - 08 Size 11	K 70 J 070 Z K 70 J 071 Z K 70 J 072 Z K 70 J 073 Z K 70 J 074 Z
Painted closing plate for CH (horizontal units) not abutting wall	Size 02 Size 03 Sizes 04 - 05 Sizes 06 - 08 Size 11	K 70 J 075 Z K 70 J 076 Z K 70 J 077 Z K 70 J 078 Z K 70 J 079 Z
Set of stands for CV Height: 100 mm	Sizes 02 to 05 Sizes 06 to 11	K 70 U 020 Z K 70 U 021 Z
Auxiliary drain pan Vertical models Horizontal models	CV, CH, NC CH, NC	K 70 L 045 Z K 70 L 046 Z

## INFRARED REMOTE CONTROL

For terminal units **2 pipe coil**, type :

- . Wall-mounted (MPW)
- . Floor/ceiling mounted (KPSW)
- . Cassette (CWX)



### Main features

- Operating modes (depending on application):
  - Cooling
  - Heating
  - Dehumidification
  - Automatic
  - Ventilation alone
- Set-point adjustment range: 10 to 32°C
- Automatic sweeping of the vertical flaps
- 3 ventilation speeds, manual or automatic selection
- On/Off action on valve
- Remote control with addressing switch (4 addresses)
- Cooling or Heating "imposed mode" function
- Protection against cold air draughts in heating mode
- Control of condensate lift pump
- "I feel" function: possibility of choosing the ambient sensor in the unit or the remote control
- "Night" function
- "Diagnosis" function for assistance with the breakdown service



### Applications:

Regulation is to be configured on installation for one of the following applications:

- "2 pipe coil" cooling only, regulation by valve  
Modes: Cooling – Dehumidification – Ventilation only
- "2 pipe coil" cooling/heating, regulation by valve  
Modes: Cooling – Heating – Dehumidification – Ventilation only
- "2 pipe coil" heating only, regulation by valve  
Modes: Heating – Ventilation only
- "2 pipe coil" cooling/heating with 2 separated pipes, regulation by 2 valves  
Modes: Cooling – Heating – Automatic – Dehumidification – Ventilation only

# TERMINAL UNITS REMOTE CONTROL

## Manual remote control

### 70250076

Electromechanical thermostat with 3 fan speeds

**Manual** selection of operating mode (heat/cool)

For units with "2 pipe coils" only or "2 pipe coils + electric heater" or "4 pipe coils"

#### Main features

- Supply voltage: 230Vac 50/60 Hz
- Functions: On/Off + 3-speed fan selector  
Manual selection of operating mode (heat/cool)
- Set-point adjustment range : 8/30°C (possibility of mechanical limitation by jumpers on the knob)
- Regulation by ON/OFF valve control
- Permanent or slaved ventilation
- Contact breakers: 2 A inductive
- Differential: 1K maxi
- Electrical connections at screw terminal block
- Operating temperature: 0 / +50°C
- Relative humidity < 95%
- Casing insulation: classe II – IP30
- Colour: white RAL 9003



## Automatic remote control

### 70250051 and 70250052

Electronic thermostat with 3 fan speeds

**Automatic** selection of operating mode (heat/cool)

70250051 : for units with "2 pipe coil"

70250052 : for units with "2 pipe coil + electric heater" or "4 pipe coil"

#### Main features

- Supply voltage: 230Vac 50/60Hz
- Functions : On/Off + 3-speed fan selector  
Supplied with built-in air temperature sensor  
Input water sensor "change/over" (70250053 as accessory)  
Input remote air temperature sensor (as accessories : uncased sensor for air intake 70250053, or cased sensor 70250054)  
Input for external contact for mode change (ECO or stand-by)
- Set-point adjustment range : 8/30°C (possibility of mechanical limitation by jumpers on the knob)
- Regulation by ON/OFF valve control
- Permanent or slaved ventilation
- Contact breakers : 2 A inductive for ventilation  
1 A inductive for valve(s)
- Differential in heating : adjustable 1 or 4 K
- Differential in cooling : adjustable 0,5 or 2 K
- Neutral zone (on RCC 20) : adjustable 2 or 5 K
- Setpoint in "Eco" mode : 16°C in heating mode  
28°C in cooling mode
- Setpoint in "Standby" : 8°C in heating mode
- Electrical connections at screw terminal block
- Operating temperature : 0/+50°C
- Relative humidity : < 95%
- Casing insulation : classe II –IP30
- Colour : white RAL 9003





